

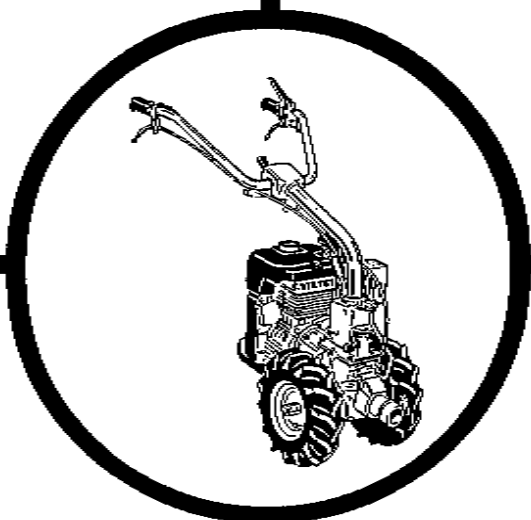

- ① **Catalogo parti di ricambio - 3^a Edizione 97**
- ② **Spare parts catalogue - 3th Edition 97**
- ③ **Catalogue des pièces détachées - 3^{me} Issue 97**



BC 90 1V - 2V - 1VL - 2VL

LEGENDA SIMBOLI USATI NEL CATALOGO RICAMBI

SIMBOLI  ecc.

Indicazione di modifica dei singoli particolari



Esempio:



 fino al N° 4200000 (il pezzo così indicato vale per la macchina fino al N° di matricola 4200000)

 dal N° 4200001 (il pezzo così indicato vale per la macchina dal N° di matricola 4200001 in poi)

SIMBOLI  ecc.

Indicazione di particolari rappresentati da un'unica figura o da figure simili

TIPO DI MACCHINA  Esempio:  ▲ BC 90 1VL
(vale per le macchine modello BC 90 1 Velocità Lenta)

MOTORI  Esempio:  □ 15 LD 315
(indica un motore tipo 15 LD 315)

SIMBOLI * A richiesta (il pezzo così indicato si fornisce solo a richiesta del Cliente)

SIMBOLI  Versione speciale

ABBREVIAZIONI Sn = Sinistro Ds = Destro

LEGEND EXPLAINING SYMBOLS USED IN SPARE PARTS CATALOGUE

SIGNS  etc.

Stand for a spare part modification



Example:

 up to N° 4200000 (part valid for the machine with Unit No up to 4200000)

 from N° 4200001 (part valid for the machine with Unit No from 4200001)

SIGNS  etc.

Stand for spare parts represented by just one picture or by similar pictures

TYPE OF MACHINE  Example:  ▲ BC 90 1VL
(valid for models BC 90 1 Slow Speed)

ENGINES  Example:  □ 15 LD 315
(means an engine type 15 LD 315)

SIGNS * Means part available on request

SIGNS  Means special version, out of standard fitting

ABBREVIATIONS Sn = Left hand Ds = Right hand

LEGENDE DES SIGNES CONVENTIONNELS EMPLOYES AU CATOLOGUE PIÈCES DE RECHANGE

SYMBOLES  etc.

Sont employés pour indiquer modification de la pièce de rechange



Exemple:



 jusqu'au N° 4200000 (la pièce ainsi signalée est à employer pour les machines ayant un N° Matricule inférieur ou égal à 4200000)

 à partir du N° 4200001 (la pièce ainsi signalée est à employer pour les machines ayant un N° Matricule égal ou supérieur à 4200001)

SYMBOLES  e

Sont employés pour indiquer des pièces représentées par une figure seulement, ou bien par des figures semblables

TYPE DE MACHINE  Exemple:  ▲ BC 90 1VL
(valable pour les machines mod BC 90 1Vitesse Lente)

MOTEURS  Exemple:  □ 15 LD 315
(indique un moteur du type 15 LD 315)

SYMBOLES * Sur demande (la pièce ainsi signalée n'est délivrée que sur demande)

SYMBOLES  Version speciale

ABBREVIATION Sn = De gauche Ds = De droite

	I CATALOGO PARTI DI RICAMBIO BC 90 1V - 2V - 1VL - 2VL	GB SPARE PARTS CATALOGUE BC 90 1V - 2V - 1VL - 2VL	F CATALOGUE DES PIECES DETACHEES BC 90 1V - 2V - 1VL - 2VL
Tav.	INDICE	TABLE OF CONTENTS	SOMMAIRE
1	CARTER CAMBIO	GEARBOX CASE	BOITE DE VITESSES
2	INGRANAGGI CAMBIO BC 90 1V - 2V - 1VL	TRANSMISSION BC 90 1V - 2V - 1VL	TRANSMISSION BC 90 1V - 2V - 1VL
3	INGRANAGGI CAMBIO BC 90 2VL	TRANSMISSION BC 90 2VL	TRANSMISSION BC 90 2VL
4	LEVE COMANDI	CONTROL LEVERS	LEVIERS DE COMMANDE
5	ASSE RUOTA	WHEELS AXLE	ESSIEU
6	SUPPORTO STEGOLE E COMANDI	SUPPORT	SUPPORT
7	STEGOLE E COMANDI	HANDLES & CONTROLS	MANCHERONS
8	PROTEZIONI PULEGGIA	PULLEY PROTECTION	PROTECTION POULIE
9	KIT FILTRO A BAGNO D'OLIO	KIT OIL BATH FILTER	KIT FILTRE EN BAIN D'HUILE

CARTER CAMBIO

BC 90 1V - 2V - 1VL - 2VL

GEARBOX CASE

BOITE DE VITESSES

TAV. 1

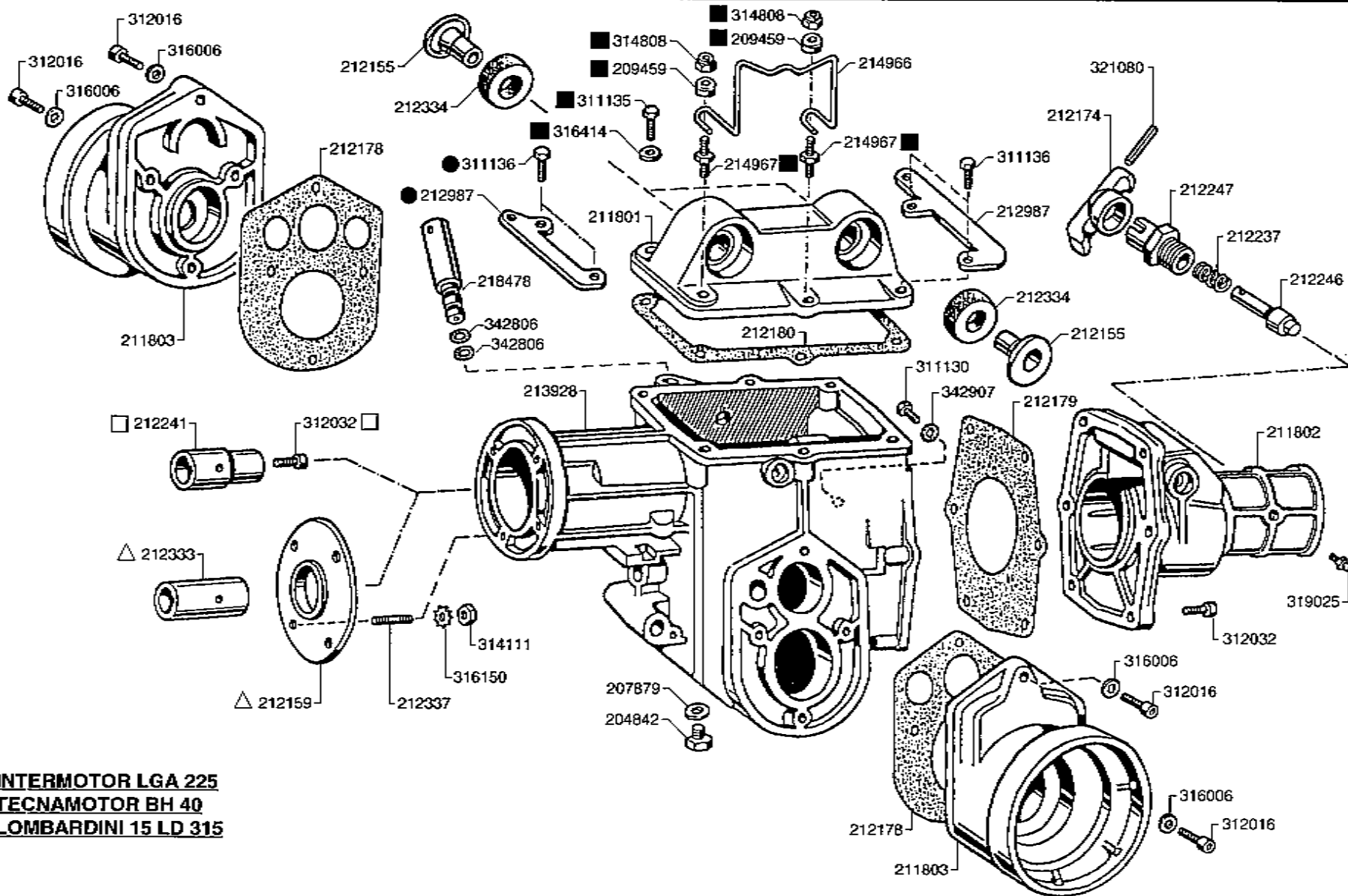

INTERMOTOR LGA 225
TECNAMOTOR BH 40
LOMBARDINI 15 LD 315



● BC 90 1V - BC 90 1VL

■ BC 90 2V - BC 90 2VL



△ BH 40

□ LGA 225 - 15 LD 315

372420

B

INGRANAGGI CAMBIO

BC 90 1V - 2V - 1VL

TRANSMISSION

TRANSMISSION

TAV. 2

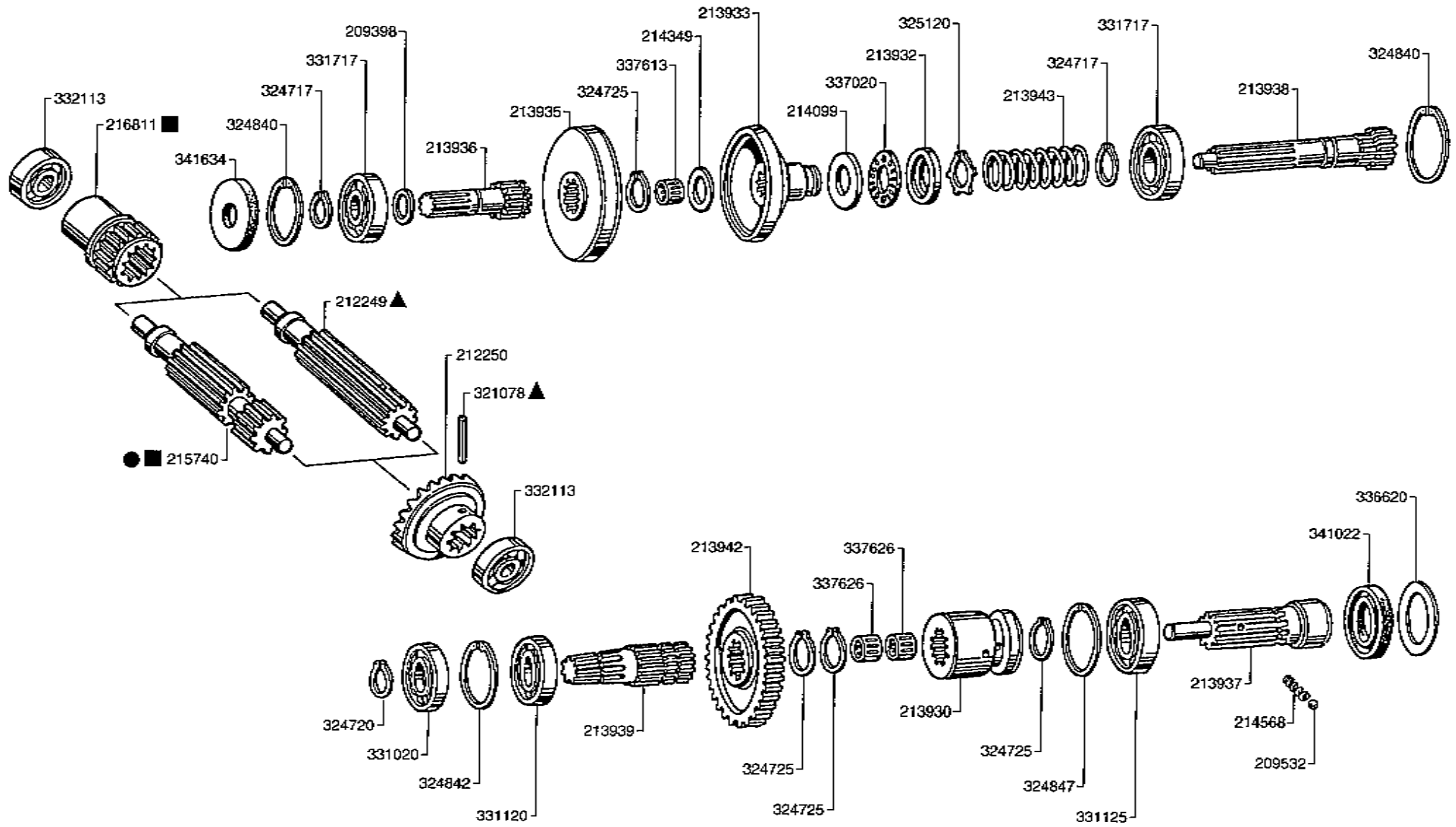

● BC 90 1V

■ BC 90 2V

▲ BC 90 1VL

372421

INGRANAGGI CAMBIO

BC 90 2VL

TRANSMISSION

TRANSMISSION

TAV. 3

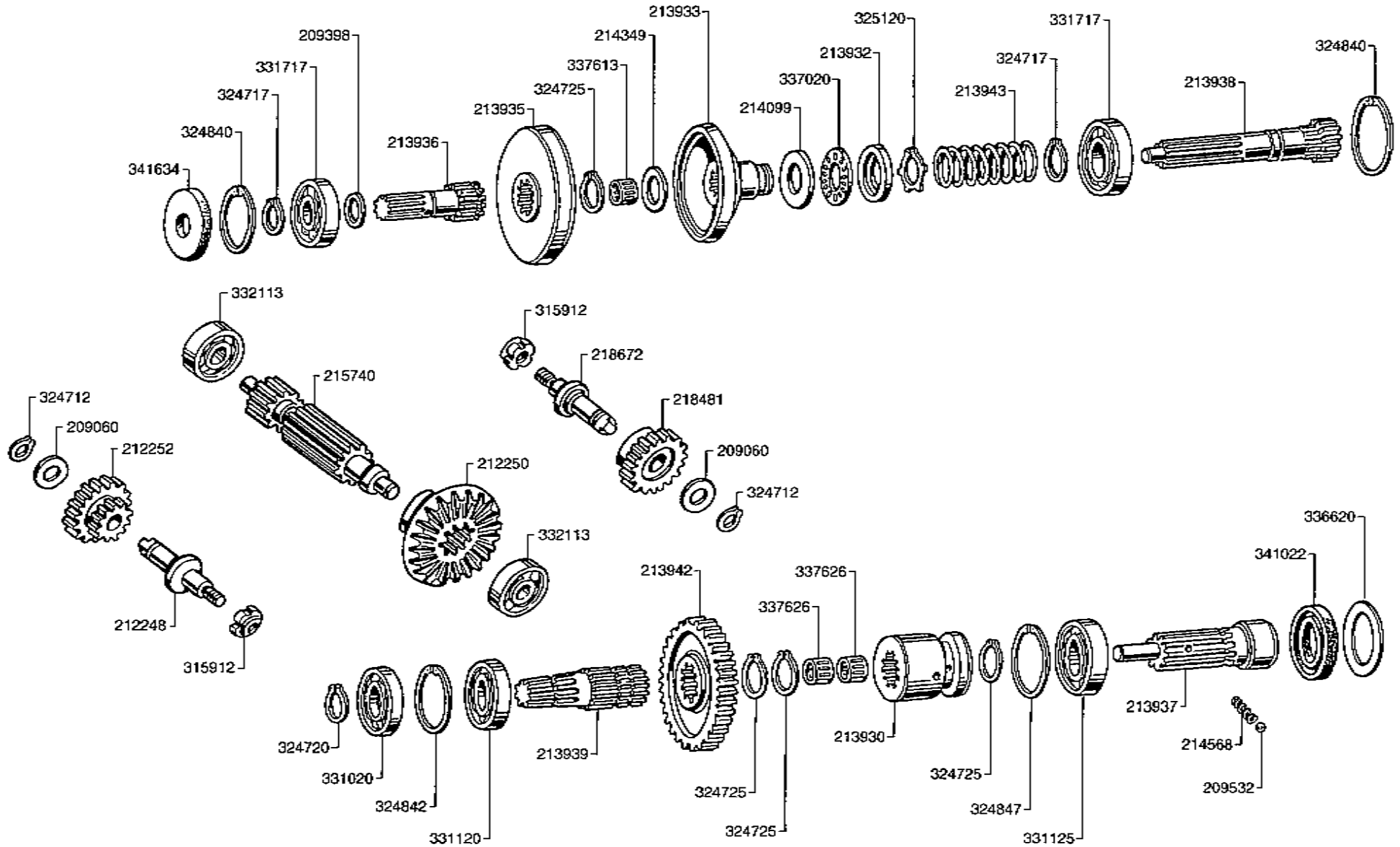

372428

LEVE COMANDI

BC 90 1V - 2V - 1VL - 2VL

CONTROL LEVERS

LEVIERS DE COMMANDE

TAV. 4

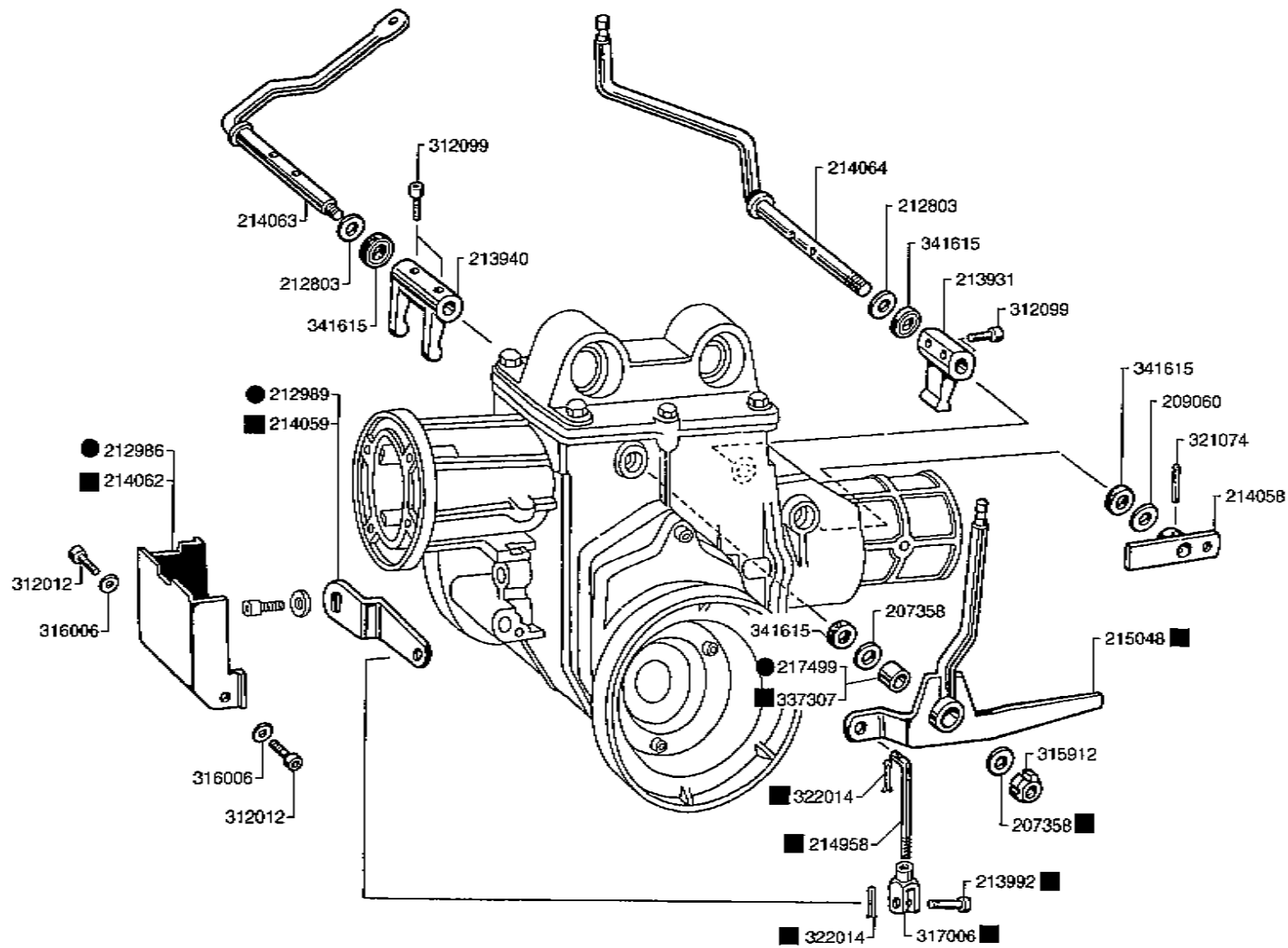

ASSE RUOTA

BC 90 1V - 2V - 1VL - 2VL

WHEELS AXLE

ESSIEU

TAV. 5

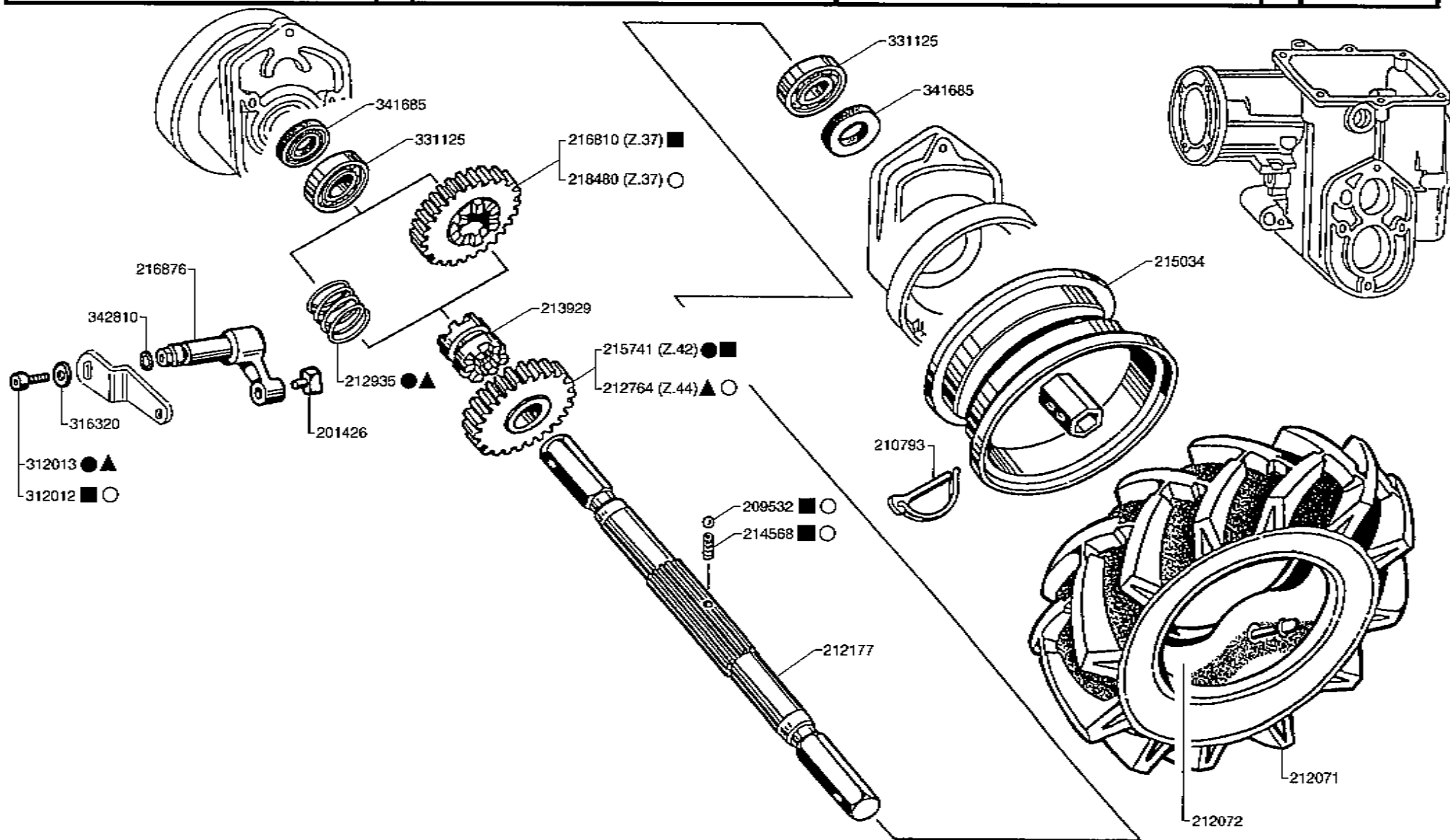

● BC 90 1V ■ BC 90 2V ▲ BC 90 1VL ○ BC 90 2VL

372423

B

SUPPORTO STEGOLE E COMANDI

BC 90 1V - 2V - 1VL - 2VL

SUPPORT

SUPPORT

TAV. 6

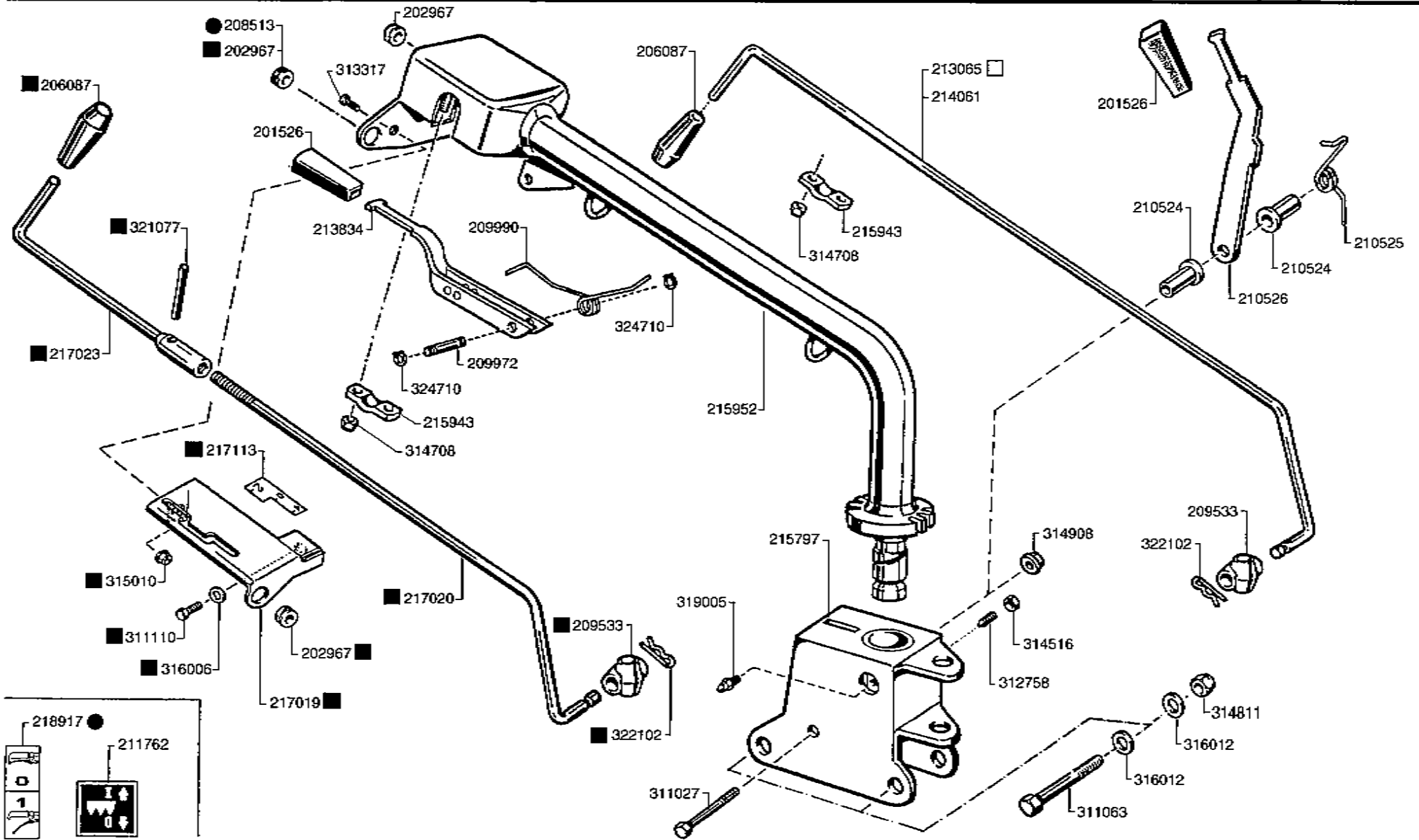

● BC 90 1V - BC 90 1VL

■ BC 90 2V - BC 90 2VL



□ 15 LD 315

372424

A

STEGOLE E COMANDI

BC 90 1V - 2V - 1VL - 2VL

HANDLES & CONTROLS

MANCHERONS

TAV. 7

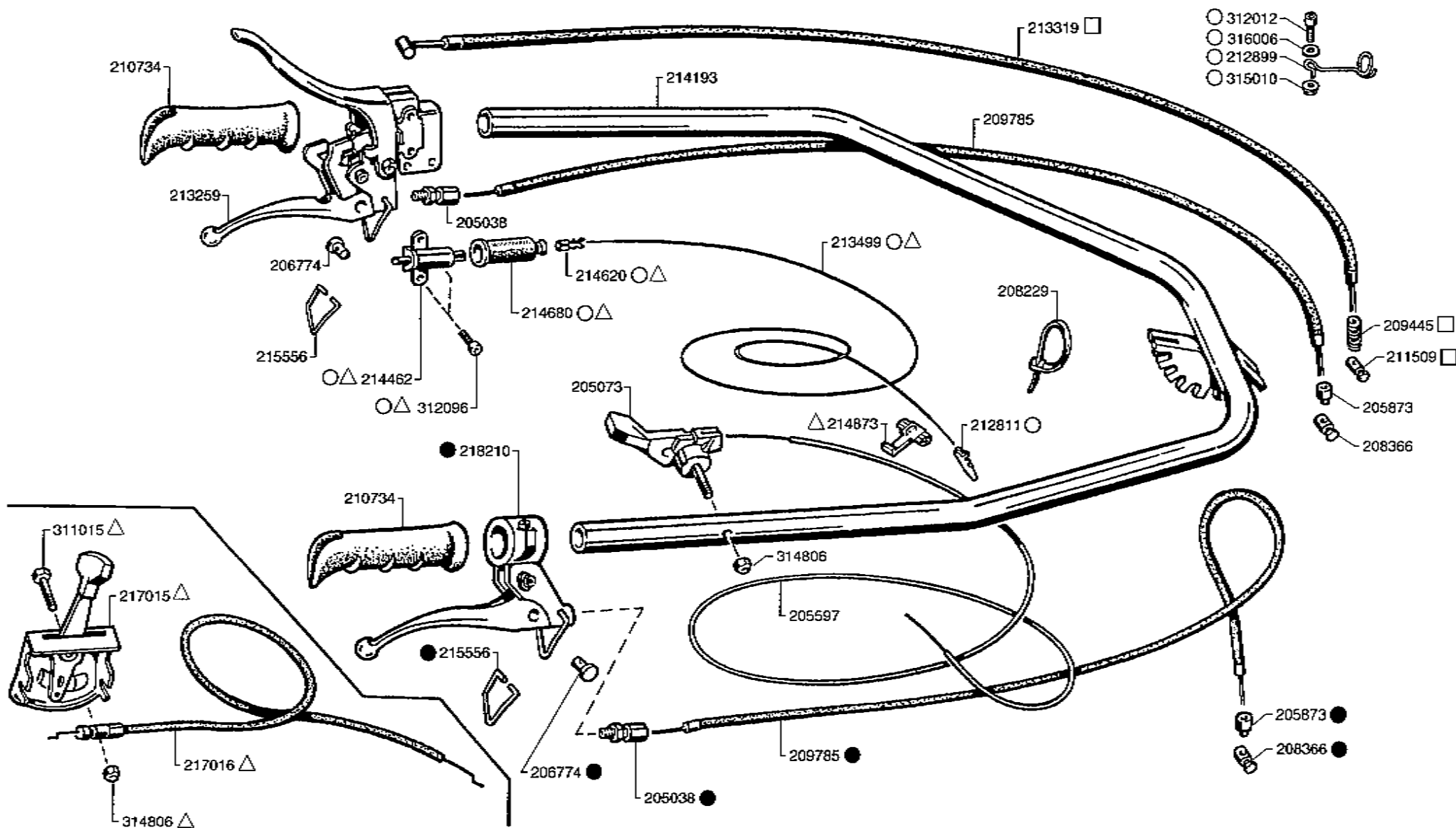

372425

A

PROTEZIONI PULEGGIA

BC 90 1V - 2V - 1VL - 2VL

PULLEY PROTECTION

PROTECTION POULIE

TAV. 8

 **INTERMOTOR LGA 225**

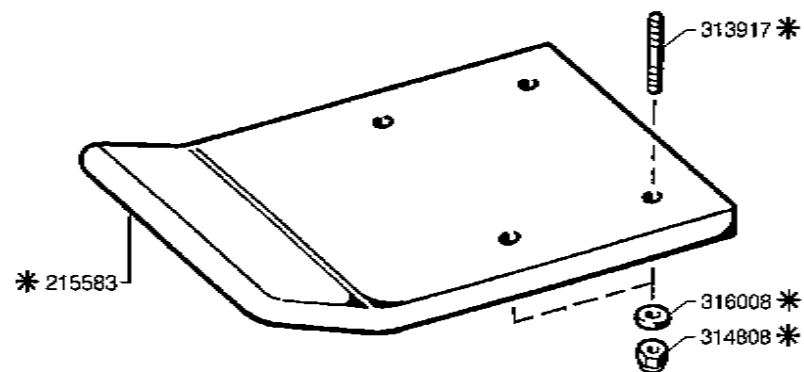
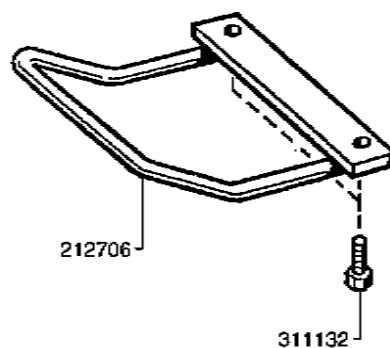
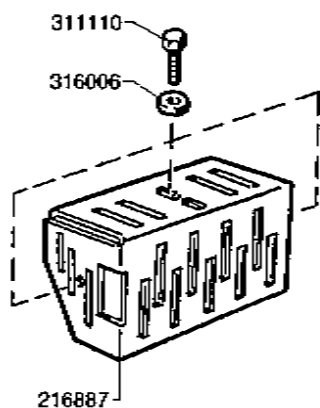

 **TECNAMOTOR BH 40**

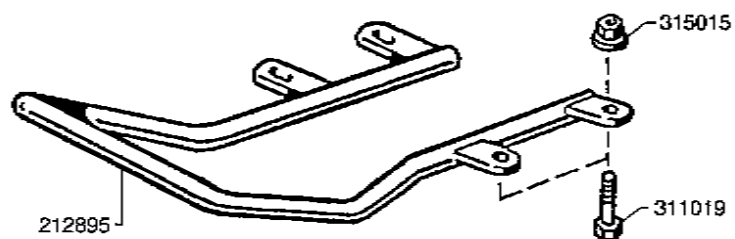
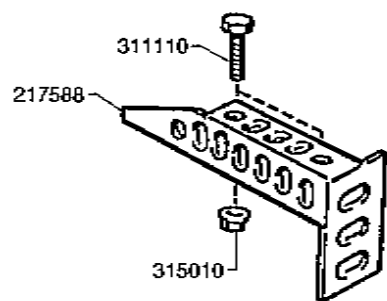

 **LOMBARDINI 15 LD 315**

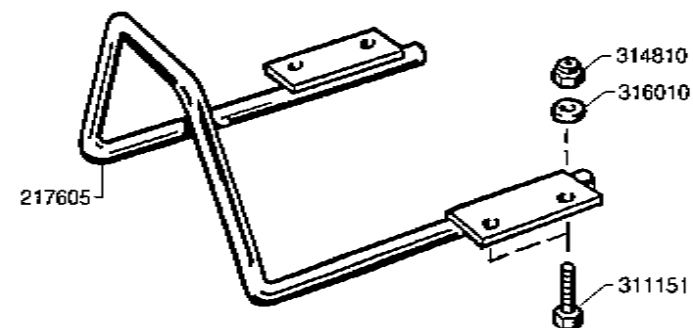

* A Richiesta
* On Request

372426

A

KIT FILTRO A BAGNO D'OLIO

BC 90 1V - 2V - 1VL - 2VL

KIT OIL BATH FILTER

KIT FILTRE EN BAIN D'HUILE

TAV. 9



TECNAMOTOR BH 40

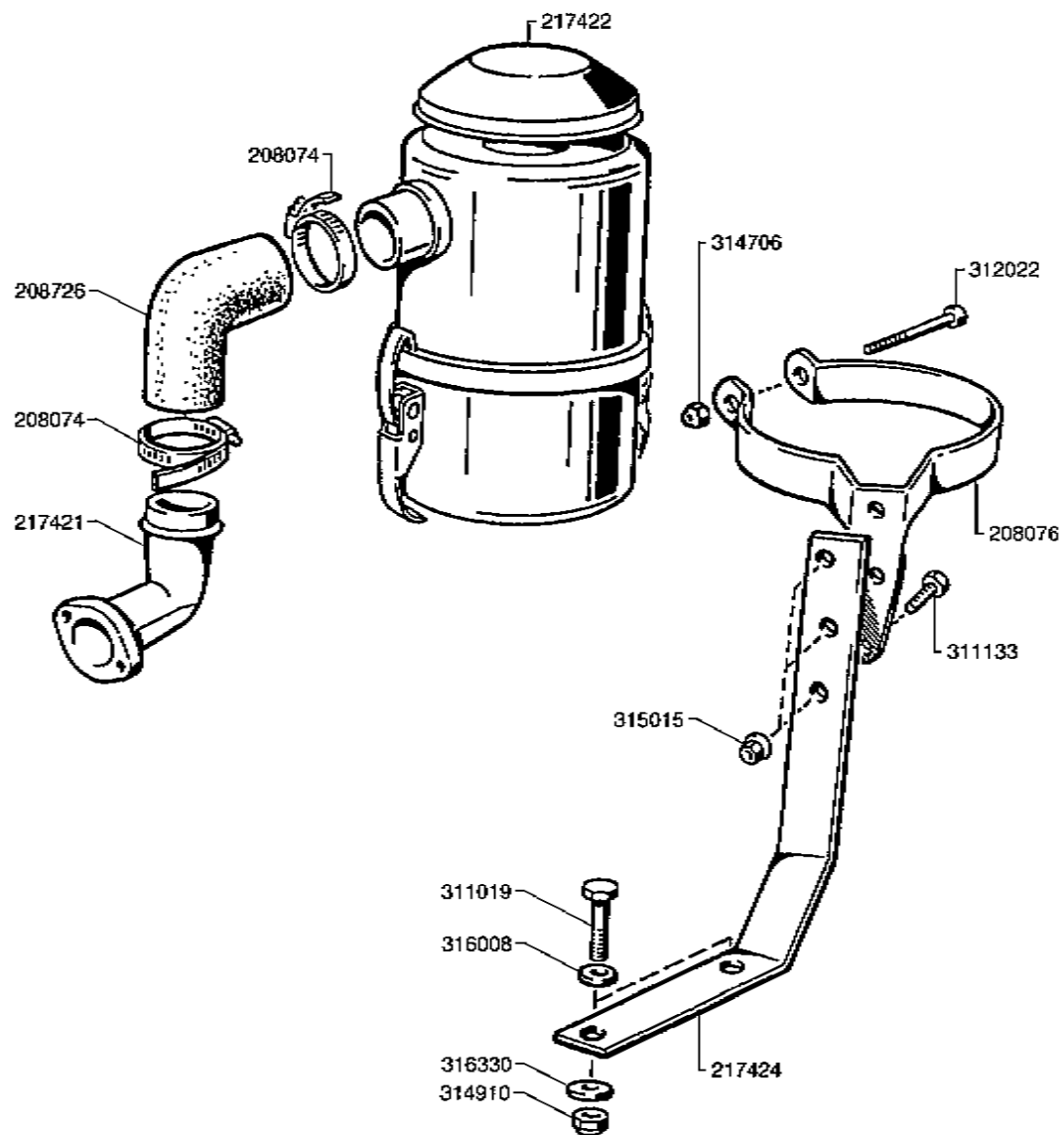

372427

A



BARBIERI S.r.L.
36040 SOSSANO (Vicenza) Italy
Via Seccalegno, 25
TEL. +39 0444 885722 - FAX. +39 0444 885482
E-MAIL: info@barbieri-fb.com